

SA705X single oven

ID280207
Code SA705X

70cm smeg thermoseal, fan forced, six functions, timer



Please note: the SA705X has a removable door and slide-out inner glass pane for easy cleaning access to all four glass door surfaces



MULTIFUNCTION



fan forced



baker's function



fan grill



defrost



convection



static grill

COLOUR	satin stainless steel
SIZE	595mmH x 698mmW x 566mmD
CAPACITY	92 litre gross; 78.7 litre net
INSTALLATION	underbench or wall (column) fascia: flush or proud mount
THERMOSTAT	variable 0–250°C
MULTIFUNCTION	five cooking functions plus defrost
TIMER	60-minute maximum variable countdown timer with ringing
CAVITY COOLING	independent self-cooling carcass fan
FURNITURE	grill/baking tray, chrome wire shelf, teflon flat tray, removable roof liner, safety-grip grill tray handles
OPTION	catalytic liners, set of three (3) removable, replaceable code 9970/90
SAFETY	thermal overload protection safety-notched furniture double-glazed door forced-air door cooling

GIANT CAPACITY

Cleverly, the capacity of a giant 90cm Smeg oven has been retained within a more compact 70cm format. The side fascia panels have disappeared and a new ceramic insulation is inserted between the carcass walls to eliminate heat transference to the adjacent cabinetry.

SMEG THERMOSEAL

Unique to smeg is the fully sealed, non-venting oven. This sealing ensures full capacity loading, lower temperatures and faster cooking.

SELF SUFFICIENCY

The thermoseal ensures cooking does not require the addition of fluids (fats, oils) to maintain a moist cooking environment. Nor does the oven require attention – that is, turning, basting or repositioning while grilling, roasting or baking.

MAXIMUM EFFICIENCY

Sustainable lower temperatures, shorter cooking durations and higher capacities combine with virtual 'hands'free' cooking in a non-polluting, non-venting system, delivering both a costing and lifestyle efficiency.

REMOVABLE ROOF

Also uniquely Smeg is the removable vitreously-enamelled roof over the grill elements. Historically this is the most inaccessible and difficult area of an oven to clean. Now, simply slide this liner out for easy wiping over or dishwasher loading.

CLEANER COOKING

Since the oven cavity is denied a vented air supply, there is reduced splatter and oxidising ('burning-on') of food particles and fluids onto interior surfaces and oven furniture.

LOW MAINTENANCE

The oven cavity is constructed of both continuous enamelled sheeting and full strip-welded panels. This, as well as ensuring the thermoseal is intact, allows for very easy access for cleaning with the absence of hidden crevices and abrupt joins. Even the rear enamelled wall is detachable for access and removal of the oven fan. All the removable parts and oven furniture (racks and trays) are dishwasher safe.

AA ANTI-ACID ENAMELLING

Baking the oven cavity at 850°C ensures super bonding of the molecular structure for an extremely low porous surface. This anti-acid process discourages pitting and decay of the enamelled surfaces by food particles, fluids and vapours. The ultra-smooth enamelled walls, floor and removable liners enables very low maintenance.

CATALYTIC WALL LINERS

These panels are purchasable accessories as a set of three and fit over the side and rear walls. They absorb airborne grease/oil/food particles, and then eventually carbonise this waste matter. Maintenance is, then, easier again.

SAFETY COOLING

An independent fan sources air from the kitchen and passes this air through the control panel and then around the carcass of the oven, exiting at the lower front of the oven back into the kitchen. The double-glazed door, in unison with the cavity cooling system, ensures all external surfaces are safe to touch.

WARRANTY

Two years parts and labour.

SA705X single oven

ID260706
Code SA705X

70cm smeg thermoseal, fan forced, six functions, timer

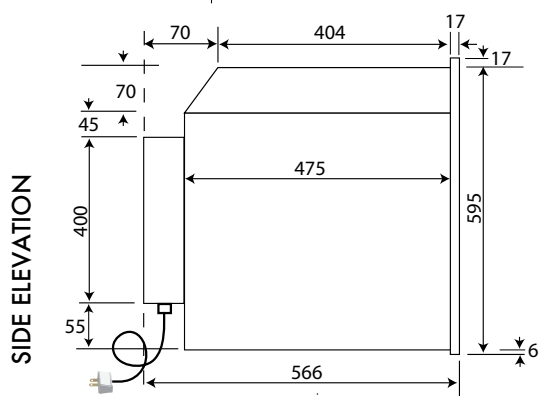
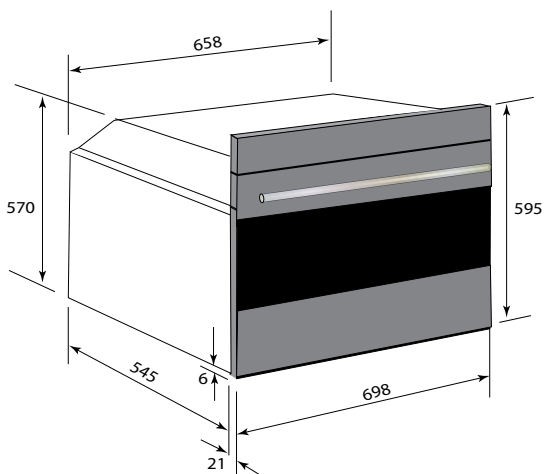

1.0 metre connected power cord
power connection 15 amp 3-pin plug

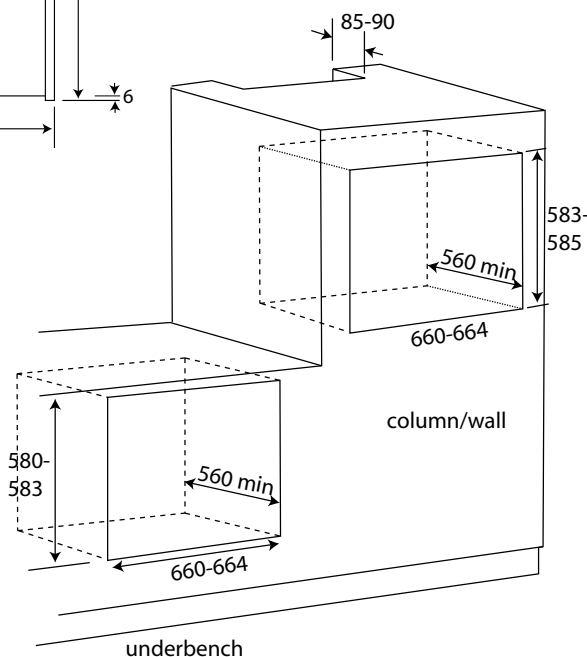

**NB: drawings are not to scale
— they are to assist only**

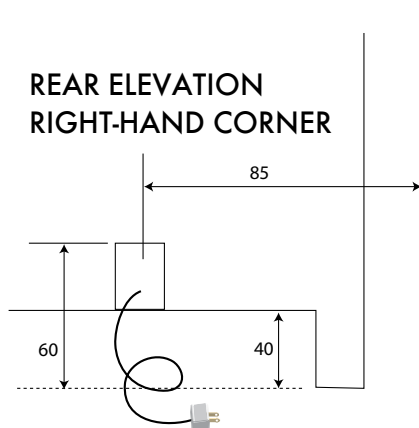

WARNING: technical specifications and product sizes can be varied by the manufacturer, without notice. Cutouts for appliances should only be by physical product measurements. The above information is indicative only.

(for flush mounting, add maximum 4mm to height and width for cabinet dimensions)

- height** 595mmH x 698mmW x 566mmD
- CUTOUT (proud mounted)**
- height** 580–583mmH x 660-664mmW x 560mmD
- packaged dimensions** 690mm x 760mm x 670mm
- gross volume** 0.35 cubic metres
- net weight** 44kg
- gross weight** 48kg
- internal oven dimensions** 340mmH x 615mmW x 440mmD = 92 litre
- net cooking dimensions** 310mmH x 605mmW x 420mmD = 78.7 litre
- maximum current** 13.2 amp
- electricity supply** 240 volt 50 Hz
- electrical connection** the oven is wired with a one-metre power cord with connected 15 amp rated 3-pin insulated plug — suitable for direct plugging to a 15 amp socket
- supplied** screws for mounting, instructions for installation, operation and maintenance, cookbook, baking/grill tray, grill grid, 2x handles, 1 x rack, teflon tray, removable roof liner

Element	Roof		Floor		Rear wall	Rear wall fan	Cooling fan	Light (2)	max watt	current amp
	inner	outer	inner	outer						
wattage	1600	1200	1200	700	2000	45	24	15		
static grill	•	•					•	•	2854	11.9
fan grill	•	•				•	•	•	2809	12.1
fan forced					•	•	•	•	2099	8.8
baker's function			•			•	•	•	1999	8.4
static convection		•	•				•	•	3154	13.2
defrost						•	•	•	99	0.4